

THE LOUISE HOUSE



PROJECT DESCRIPTION:

“Create a space to function as a vacation rental unit for up to two guests. This structure will depict modern interior and exterior styles and include high end finish materials and amenities. The interior will feature an open concept plan and include an open loft.”



FRONT ELEVATION: TIME OF DAY: 7:45 P.M.

CONCEPT STATEMENT:

The concept of this design is to allow for a modern, but simple approach to vacation living. The space will be designed minimally but with high end finishes, appliances, and ambiance. The design will be located in Alberta, Canada on Lake Louise, with the front façade facing south so that the large picture windows will face east where the sun rises.

Other elements of this design include an earth-tone color scheme focusing on the vast amount of nature and greenery in the Lake Louise area. A major focal point of the interior of the house will include a structural wall coated with reflective copper tiles, giving a high end appearance but with minimal intrusion. Other focal points include a large and cozy fireplace coated with local stone in a deep and saturated sand-brown color, as well as limestone accents.

Exterior elements of the house will include weather resistant brick as the main coating of the house, as well as a wrap-around patio featuring warm and rich brown and red pavers. Other focuses come from the exterior pergola which shelters the extravagant hot tub, an off-side wet bar with a grill for entertaining and a patio table set to compliment the exterior finishes.

INSPIRATION

Figure 1 represents the shed roof featured in this design, as well as rough exposed brick. The main focus of the design also comes from large windows that let in natural light.

Figure 2 represents the exposed brick on the exterior of the design as well as a general representation of the tall ceilings that are featured in the design with the addition of the loft as well as the shed roof, allowing for higher pitched ceilings.

Figure 3 is one of the most popular pictures or angles featured when searching Lake Louise in Alberta, Canada. The building shown is the popular and well-known Fairmont Chateau – Lake Louise. The upscale and lavish Chateau is one of the many things people first think of if they are familiar with the Lake Louise area. The lake and Chateau also sit within Banff National Park, so the surrounding mountainous area is filled with greenery and nature.



FIGURE 1



FIGURE 2



FIGURE 3

3D EXTERIOR VIEWS



LEFT ELEVATION



EXTERIOR/LEFT ELEVATION

3D INTERIOR VIEWS



Interior Perspective from Kitchen. Time of day: 8:00 p.m.



Interior Perspective from Living Area. Time of day: 4:00 p.m.

2D FLOOR PLANS

TOTAL SQUARE
FOOTAGE: 1,500 SQ. FT

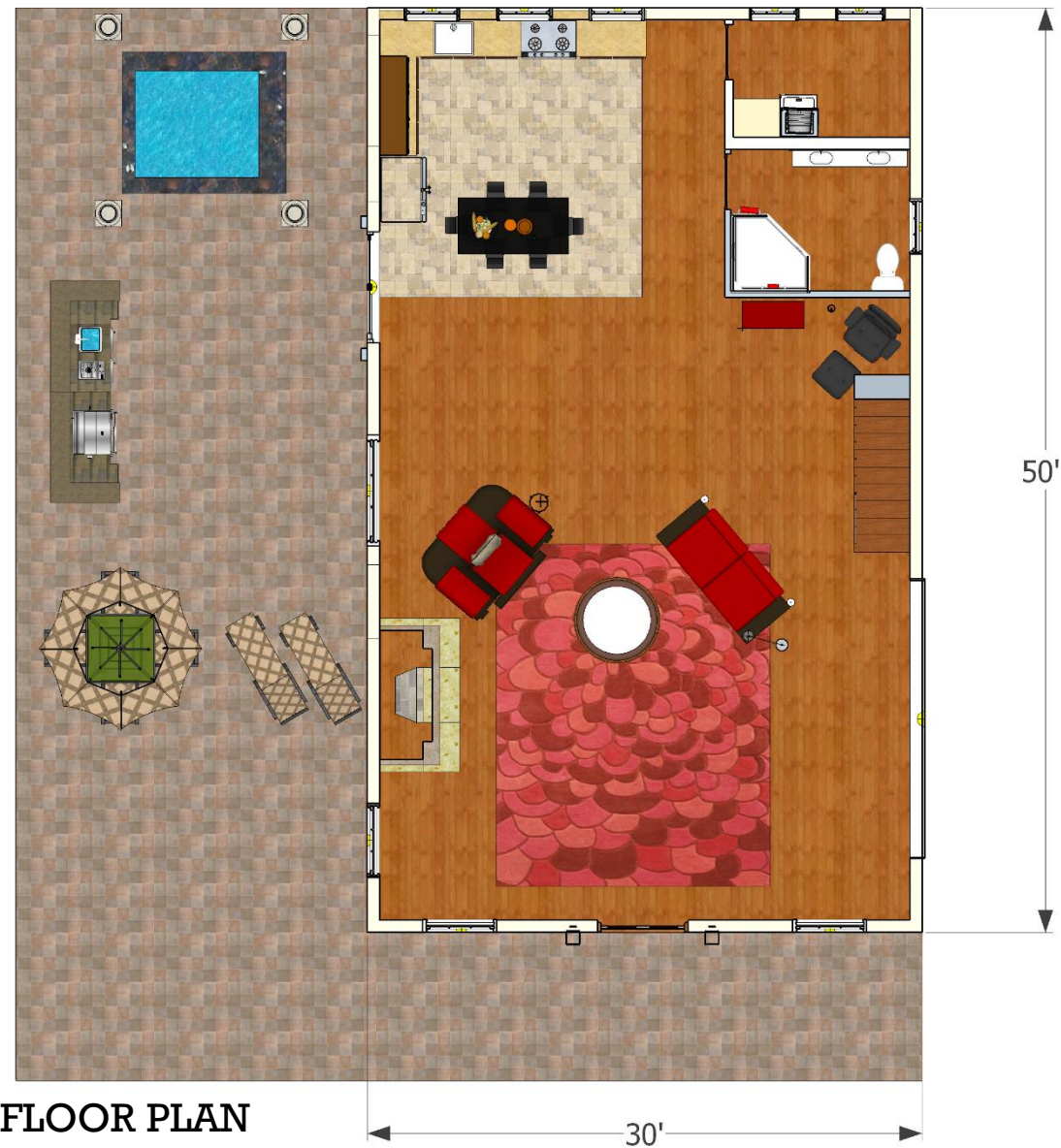

FLOOR PLAN
SCALE: 1/8" = 1'-0"



LOFT PLAN
SCALE: 1/8" = 1'-0"

ADDITIONAL VIEWS



Interior Perspective from couch. Time of day: 6:00 a.m.



Interior Perspective from loft. Time of day: 8:00 a.m.



Exterior Perspective of Bathroom. Time of day: 12:30 p.m.



Interior Perspective from Fireplace. Time of day: 9:45 p.m.

LANDSCAPING

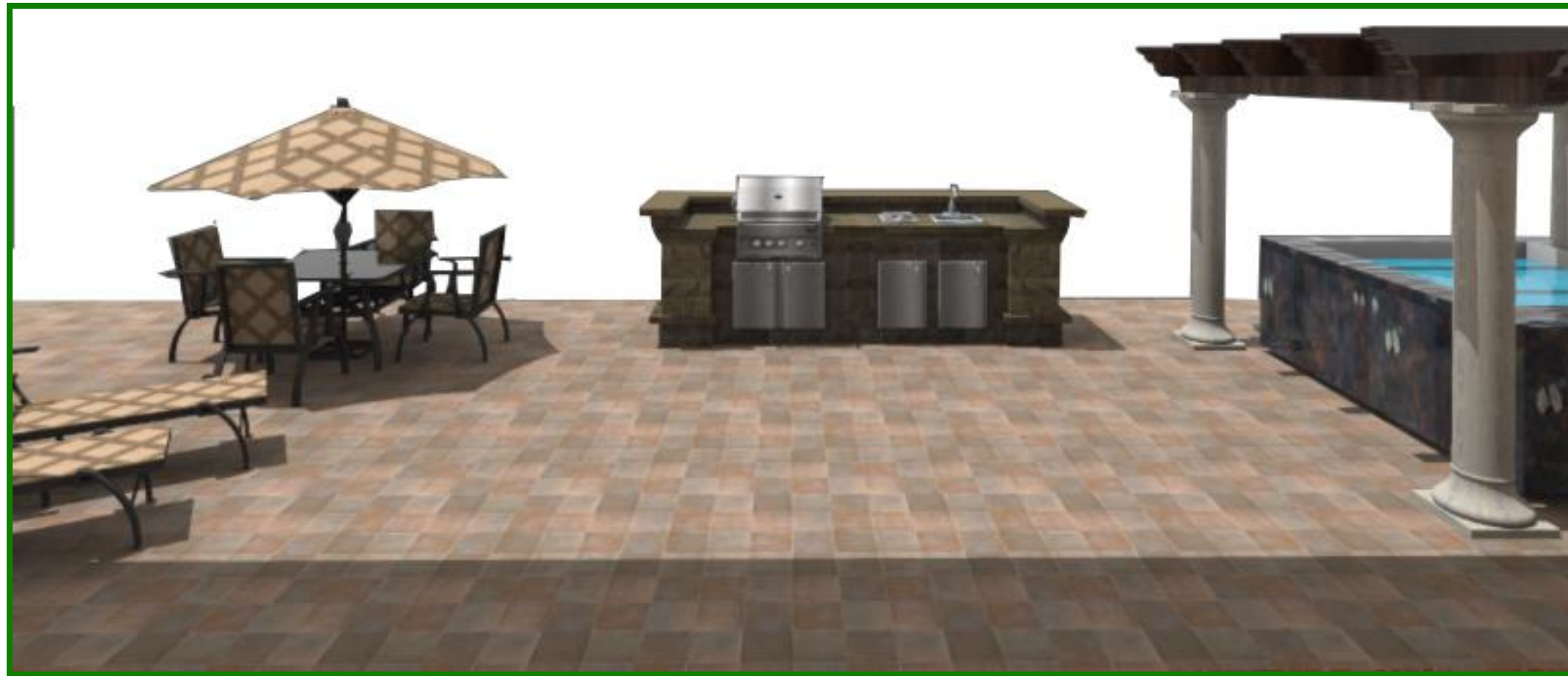

PATIO VIEW: TIME OF DAY: 11:45 A.M.